



| Catalog No. | Form | D  | d <sub>1</sub> |
|-------------|------|----|----------------|
| SM 1265     | C    | 32 | M08            |



Knopf: **KT:** Kunststoff (Duroplast PF), entgratet und poliert  
 Klemmhülse: (Form L) aus Federstahl  
 Buchse: **St:** Stahl, verzinkt  
**MS:** Messing  
  
 knob: plastic  
 tolerance ring: (form L), spring steel  
 bushes: **St:** steel, zinc plated  
**MS:** brass



schwarz / black



mm



**Knöpfe aufgeschraubt / screwed on:**  
 Form C: Kunststoffgewinde ohne Buchse / plastic thread  
 - Duroplast  
 Form E: mit Gewindebuchse / thread bush  
**KT:** Duroplast, entgratet und poliert  
 - Buchse St: Stahl  
 - Buchse MS: Messing

**Knöpfe aufgeschlagen / press on type:**  
 Form L: mit Klemmhülse, Duroplast, schwarz glänzend / tolerance ring



andere Farben (rot) und Werkstoffe  
 other colors and materials

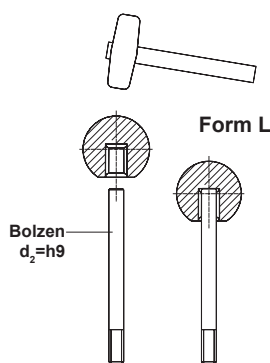

Die Kugelknöpfe der Form L mit Klemmhülse werden durch leichte Hammerschläge auf das Gegenstück aufgetrieben. Sie halten ohne Verkleben fest und verdrehungssicher.

The ball knobs are driven on to the shaft with light mallet blows to the ball knobs. The shaft end should have a radius or a chamfer. For ball knobs DIN 319 type L the shaft does not require a thread.

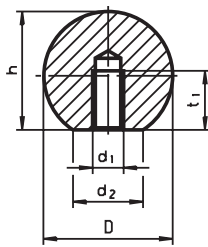

Form C

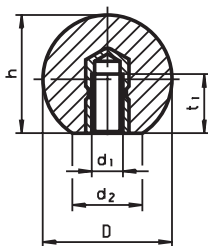

Form E

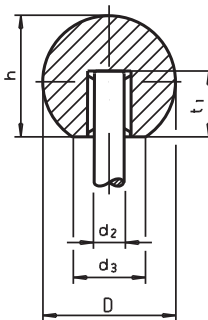

Form L

| Form C: Kunststoffgewinde / Plastic thread |                |      |                |                |      |
|--|----------------|------|----------------|----------------|------|
| D  | d <sub>1</sub> | €    | t <sub>1</sub> | d <sub>2</sub> | h    |
| ∅  | ∅              |      |                | ∅              |      |
| 10   | M03            | 0,33 | 5,0            | 05             | 9,5  |
| 12   | M04            | 0,34 | 8,0            | 06             | 11,0 |
| 16   | M04            | 0,34 | 8,0            | 08             | 15,0 |
| 20   | M05            | 0,36 | 10,5           | 12             | 18,0 |
| 25   | M06            | 0,42 | 13,5           | 15             | 22,5 |
| 32   | M08            | 0,55 | 16,0           | 18             | 29,0 |
| 36   | M08            | 1,06 | 16,0           | 16             | 34,0 |
| 40   | M10            | 0,89 | 21,0           | 22             | 37,0 |
| 45   | M10            | 1,28 | 21,0           | 17             | 43,0 |
| 50   | M12            | 1,56 | 25,0           | 29             | 46,0 |
| 60   | M16            | 2,90 | 30,0           | 20             | 57,0 |

| Form E: Gewindebuchse / Thread bush |                |      |                |                |      |
|-------------------------------------|----------------|------|----------------|----------------|------|
| D                                   | d <sub>1</sub> | €    | t <sub>1</sub> | d <sub>2</sub> | h    |
| ∅                                   | ∅              |      |                | ∅              |      |
| 16                                  | M04            | 0,68 | 8,0            | 08             | 15,0 |
| 20                                  | M05            | 0,35 | 10,5           | 12             | 18,0 |
| 25                                  | M06            | 0,44 | 13,5           | 15             | 22,5 |
| 32                                  | M08            | 0,62 | 16,0           | 18             | 29,0 |
| 36                                  | M08            | 0,95 | 16,0           | 16             | 34,0 |
| 40                                  | M10            | 1,00 | 21,0           | 22             | 37,0 |
| 45                                  | M10            | 1,36 | 21,0           | 17             | 43,0 |
| 50                                  | M12            | 1,64 | 25,0           | 29             | 46,0 |
| 60                                  | M16            | 2,81 | 30,0           | 20             | 57,0 |

| Form L: mit Klemmhülse / Tolerance ring |                |      |                |                |      |
|---|----------------|------|----------------|----------------|------|
| D                                       | d <sub>2</sub> | €    | d <sub>3</sub> | t <sub>1</sub> | h    |
| ∅                                       | ∅              |      | ∅              |                |      |
| 16                                      | 04             | 1,16 | 8              | 11,0           | 15,0 |
| 20                                      | 05             | 1,21 | 12             | 13,0           | 18,0 |
| 25                                      | 06             | 1,20 | 15             | 16,0           | 22,5 |
| 25                                      | 08             | 1,20 | 15             | 15,0           | 22,5 |
| 25                                      | 10             | 1,20 | 15             | 15,0           | 22,5 |
| 32                                      | 08             | 1,43 | 18             | 15,0           | 29,0 |
| 32                                      | 10             | 1,43 | 18             | 20,0           | 29,0 |
| 32                                      | 12             | 1,43 | 18             | 20,0           | 29,0 |
| 40                                      | 10             | 1,95 | 22             | 20,0           | 37,0 |
| 40                                      | 12             | 1,95 | 22             | 23,0           | 37,0 |
| 40                                      | 16             | 1,95 | 22             | 23,0           | 37,0 |
| 50                                      | 12             | 3,08 | 28             | 20,0           | 46,0 |
| 50                                      | 16             | 3,08 | 28             | 23,0           | 46,0 |
| 50                                      | 20             | 3,09 | 28             | 28,0           | 46,0 |



Reinigen mit  
**SM 1306**  
 Clean with  
 Seite 360



Sichern mit  
**SM 1301**  
 Lock with  
 Seite 357