

	Catalog No.	Form	d₁	X	l₂
	SM 1141	A	M06	X	30



Schraube / screw

Form A, B, BV, F, FV: Stahl, Güte 12.9 schwarz
steel, quality 12.9, blackened

Form AN, BN, BNV, FNV: Niro / stainless steel

Kugel / ball

Form A, B, BV, F, FV: Stahl gehärtet, blank
ball-bearing steel, hardened

Form AN, BN, BNV, FNV: Niro / stainless steel



Auflagefläche / contact surface



Kugel / ball
Form A, AN

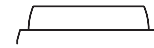

abgeflacht / plain
Form B, BN, BV, BNV

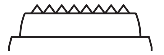

geriffelt / ridged
Form F, FV, FNV

Verdrehsicherung / thread lock

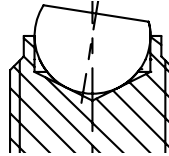

ohne / without
Form A, B, F
Form AN, BN

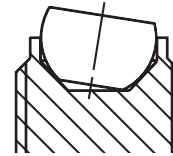

abgeflacht / flattened
Form BV: M06 - M08
Form BNV: M06 - M16
Form FV: M06 - M08
Form FNV: M06 - M16

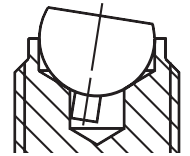

Zapfen / pin
Form BV: M08 - M24
Form FV: M10 - M24



mm



andere Größen
other dimensions



RoHS
Konform
Compliant



d ₁ Ø	l ₂ Nennlänge Nominal value	€ Form									d ₂ Ø	d ₃ Ø	l ₁	l ₃	l ₄	Kugel Ball Ø	SW	F max. [kN] stat.	kg	
		A	AN	B	BN	BV	BVN	F	FV	FNV										
M06	20	1,88	2,92	2,61	4,42	8,45	9,20	-	12,99	14,45	10	3,2	20,8	6	3,0	4,0	05	9	0,007	
	30	1,91	2,95	2,64	4,42	8,47	9,22	-	13,08	14,54									3,0	0,009
	40	1,94	2,99	2,67	4,49	8,54	9,30	-	13,12	14,56									16,0	0,011
M08	20	2,21	3,37	3,14	5,49	9,16	10,01	-	15,30	16,98	13	4,5	21,2	8	3,5	5,5	06	15	0,014	
	35	2,28	3,70	3,21	5,85	9,22	10,05	-	15,37	17,06									3,5	0,019
	50	2,38	4,11	3,37	6,28	9,31	10,14	-	15,46	17,14									22,0	0,025
M10	25	2,78	4,42	3,69	6,78	10,00	11,22	13,07	18,88	20,78	16	6,0	26,7	10	4,5	7,0	08	20	0,026	
	40	2,89	4,75	3,84	7,13	10,09	11,32	13,19	18,98	20,88									4,5	0,034
	60	3,08	5,14	3,98	7,50	10,18	11,41	13,27	19,07	20,98									28,0	0,047
M12	30	3,47	5,90	5,14	8,97	11,70	13,27	14,53	20,59	22,89	18	7,2	32,0	12	5,0	8,5	10	30	0,040	
	50	3,63	6,56	5,36	9,63	11,79	13,37	14,60	20,74	23,03									5,0	0,056
	80	4,00	7,22	5,80	10,29	12,06	14,25	14,82	20,99	23,77									44,0	0,083
M16	40	4,63	10,09	7,37	15,22	15,02	17,91	16,98	24,19	27,56	24	10,7	43,3	16	6,0	12,0	14	60	0,091	
	60	4,94	10,19	7,82	15,48	15,36	18,82	17,28	24,43	28,12									6,0	0,122
	80	5,46	11,61	8,36	16,63	15,83	23,51	17,72	25,10	29,95									36,0	0,154
M20	50	8,54	-	13,71	-	-	-	-	-	-	30	13,5	54,2	20	7,5	15,0	17	90	0,190	
	80	9,21	-	14,32	-	-	-	-	-	-									28,0	0,260
	100	10,02	-	15,09	-	-	-	-	-	-									48,0	0,310
M24	60	14,91	-	20,56	-	-	-	-	-	-	36	15,8	64,7	24	9,0	18,0	19	120	0,330	
	90	17,74	-	23,36	-	-	-	-	-	-									30,0	0,435
	120	27,33	-	24,62	-	-	-	-	-	-									60,0	0,540