

Catalog No. SM 1142
Form A
d₁ M10
X | l₁ X 12



Schraube / screw

Form A, B, BV, D, F, FV: Stahl, Güte 12.9 schwarz / steel, quality 12.9, blackened
 Form AN, BN, BNV, FNV: Nirol / stainless steel

Kugel / ball

Form A, B, BV, F, FV: Stahl gehärtet, blank / ball-bearing steel, hardened
 Form AN, BN, BNV, FNV: Nirol / stainless steel
 Form D: Thermoplast (POM)



mm



andere Größen / other dimensions



RoHS Konform Compliant



Auflagefläche / contact surface



Kugel / ball
Form A, AN, D

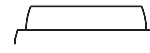

abgeflacht / plain
Form B, BN, BV, BNV

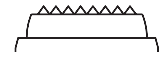

geriffelt / ridged
Form F, FV, FNV

Verdrehsicherung / thread lock

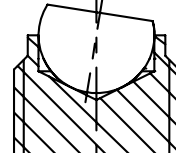

ohne / without
Form A, B, D, F
Form AN, BN

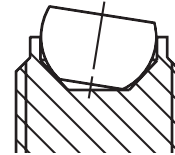

abgeflacht / flattened
Form BV: M06 - M08
Form BNV: M06 - M16
Form FV: M06 - M08
Form FNV: M06 - M16

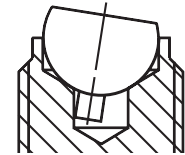

Zapfen / pin
Form BV: M08 - M24
Form FV: M10 - M24



d ₁ Ø	l ₁	l ₂	€ Form											d ₃ Ø	Kugel Ball Ø	SW	F max. [kN] stat.	kg
			A	AN	B	BN	BV	BNV	D	F	FV	FNV						
			M04	06	-	1,52	2,13	2,56	3,41	-	-	1,71	-					
	10	-	1,52	2,15	2,60	3,42	-	-	1,71	-	-	-	-			-	0,001	
	16	-	1,52	2,20	2,63	3,47	-	-	1,71	-	-	-	-			-	0,001	
M05	08	-	1,42	1,97	2,66	3,65	-	-	1,64	-	-	-	-	3,0	2,5	-	0,001	
	12	-	1,42	1,97	2,66	3,73	-	-	1,64	-	-	-	-			-	0,001	
	20	-	1,47	2,00	2,77	3,84	-	-	1,67	-	-	-	-			-	0,002	
M06	10	10	1,42	2,12	2,46	4,06	7,21	7,59	1,63	-	12,36	13,21	3,2	4,0	3,0	9	0,002	
	16	16	1,42	2,15	2,49	4,16	7,23	7,61	1,63	-	12,40	13,24					0,002	
	25	25	1,47	2,19	2,52	4,21	7,27	7,67	1,67	-	12,47	13,31					0,004	
M08	10	10	1,42	2,35	2,88	4,80	7,77	8,33	1,67	-	14,20	15,16	4,5	5,5	4,0	15	0,003	
	12	12	1,42	2,39	2,88	4,83	7,79	8,34	1,67	-	14,22	15,18					0,003	
	20	20	1,42	2,43	2,92	4,87	7,83	8,38	1,67	-	14,29	15,27					0,006	
	30	30	1,47	2,46	2,96	4,87	7,90	8,40	1,71	-	14,36	15,35					0,009	
M10	12	12	1,64	2,67	2,92	5,46	8,47	9,09	1,95	12,16	17,55	18,77	6,0	7,0	5,0	20	0,005	
	16	16	1,64	2,76	2,96	5,51	8,49	9,12	1,95	12,16	17,60	18,79					0,007	
	25	25	1,69	2,89	2,96	5,54	8,55	9,21	2,01	12,23	17,99	18,88					0,011	
	35	35	1,80	2,95	3,14	5,62	8,64	9,32	2,08	12,30	18,06	18,98					0,016	
M12	16	16	1,88	3,28	4,00	6,89	9,96	10,69	2,41	13,27	19,18	20,27	7,2	8,5	6,0	30	0,010	
	20	20	1,88	3,43	4,06	6,96	10,01	10,74	2,41	13,27	19,21	20,31					0,012	
	30	30	2,04	3,56	4,16	7,13	10,15	10,89	2,60	13,50	19,28	20,42					0,019	
	40	40	2,23	3,80	4,25	7,22	10,30	11,03	2,78	13,62	19,38	20,52					0,029	
M16	20	20	3,06	5,95	6,28	12,03	12,77	14,73	-	15,59	21,98	24,17	10,7	12,0	8,0	60	0,022	
	25	25	3,06	6,23	6,37	12,13	12,90	14,91	-	15,59	22,03	24,24					0,028	
	35	35	3,21	6,59	6,52	12,36	13,05	15,71	-	15,70	22,13	24,35					0,041	
	50	50	3,41	7,29	6,64	12,33	13,28	17,73	-	15,83	22,30	25,38					0,048	
M20	30	30	7,04	-	11,72	-	-	-	-	-	26,17	-	13,5	15,0	10,0	90	0,054	
	40	40	7,22	-	11,85	-	-	-	-	-	26,38	-					0,074	
	50	50	-	-	-	-	-	-	-	-	26,58	-					0,094	
	60	60	7,92	-	12,36	-	-	-	-	-	-	-					0,120	
M24	35	35	10,32	-	12,36	-	-	-	-	-	-	-	15,8	18,0	12,0	120	0,090	
	50	50	11,18	-	16,48	-	-	-	-	-	-	-					0,130	
	80	80	13,50	-	18,63	-	-	-	-	-	-	-					0,235	