

SM 1083-1

Stützschrauben Adjusting screws

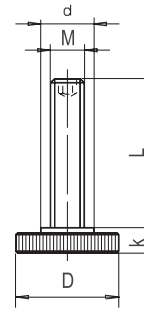

Catalog No.	M	X	L
SM 1083-1	M10	X	39



Vergütungsstahl, Festigkeitsklasse 8.8
heat treated steel, grade 8.8



mm



M x L	€	D ∅	d ∅	k	kg
M10 x 39	9,57	30	16	08	0,052
M12 x 49	10,07	36	20	10	0,096
M12 x 94	14,41				0,145
M16 x 55	12,54	42	25	13	0,180
M16 x 90	17,05				0,230
M20 x 69	18,70	50	25	16	0,320
M20 x 109	21,67				0,400
M24 x 87	27,94	60	34	20	0,590
M24 x 137	36,63				0,820

3

SM 1084

Spanneisen verstellbar, gekröpft Adjustable clamp with goose-neck

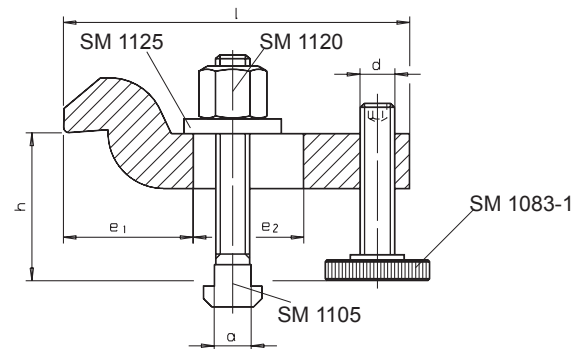
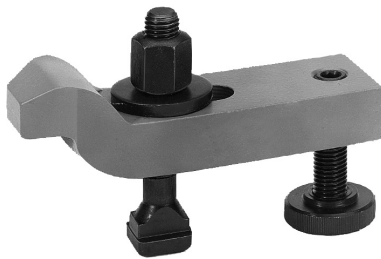

Catalog No.	Form	a
SM 1084	A	16 + 18



Vergütungsstahl, lackiert
heat treated steel, varnished



mm

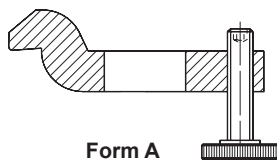

Form A

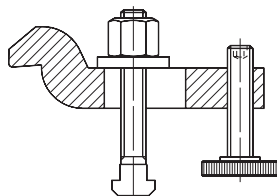

Form B



a	€	h	ähnl. / like DIN 6316 b ₁ x l	SM 1105 T-Nutenschraube T-bolts	d ∅	e ₁	e ₂	kg
Form A								
10	21,30	22 - 51	11 x 100	-	M10	32	32	0,320
12 + 14	27,72	28 - 65	14 x 125	-	M12	40	40	0,760
16 + 18	37,18	36 - 75	18 x 160	-	M16	49	50	1,480
20 + 22	60,50	43 - 92	22 x 200	-	M20	55	70	2,690
24 + 28	83,05	52 - 115	26 x 200	-	M24	73	60	4,000
Form B								
10	31,24	22 - 46	11 x 100	M10 x 10 x 080	M10	32	32	0,420
12	36,30	28 - 58	14 x 125	M12 x 12 x 100	M12	40	40	0,920
14	36,30	28 - 56	14 x 125	M12 x 14 x 100				0,920
16	49,28	36 - 71	18 x 160	M16 x 16 x 125	M16	49	50	1,830
18	49,28	36 - 69	18 x 160	M16 x 18 x 125				1,830
20	78,10	43 - 92	22 x 200	M20 x 20 x 160	M20	55	70	3,350
22	78,10	43 - 92	22 x 200	M20 x 22 x 160				3,360