

Catalog No.	d <sub>1</sub>	X	h
SM 1280-4	08	X	12

- Stahl steel
- gehärtet und geschliffen hardened and ground

mm



d <sub>1</sub>	h	kg	d <sub>1</sub>	h	kg	d <sub>1</sub>	h	kg	d <sub>1</sub>	h	kg
05	08	0,001	10	0,002	12	0,002	16	0,002	05	04	07
06	10	0,003	12	0,004	16	0,004	20	0,005	06	05	08
08	12	0,006	16	0,008	20	0,009	25	0,011	08	06	11
10	16	0,013	20	0,015	25	0,019	32	0,021	10	08	14
12	20	0,020	25	0,032	32	0,035	40	0,038	12	10	16
14	20	0,035	25	0,038	32	0,042	40	0,046	14	12	20
16	25	0,041	32	0,053	40	0,060	50	0,076	16	14	25
20	25	0,053	32	0,078	40	0,081	50	0,116	20	16	28

SM 1280-5

Aufnahmebolzen abziehbar  
Locating pin, changeable

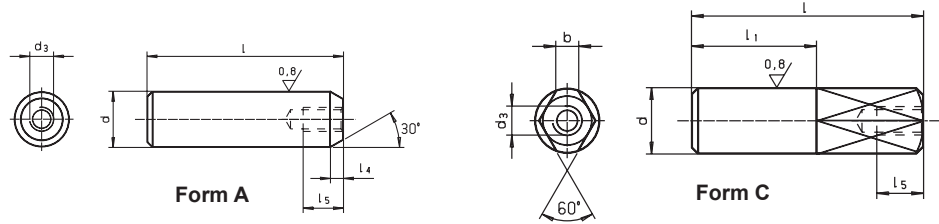

Catalog No.	Form	d	X	l
SM 1280-5	A	08	X	25

- Werkzeugstahl tool steel
- gehärtet und geschliffen hardened and ground

mm



d h6	l	d <sub>3</sub>	l <sub>1</sub>	l <sub>4</sub>	l <sub>5</sub>	b	kg	
08	25	M03	14	3,0	6,0	2,2	Form A	Form C
10	30	M03	17	3,0	6,0	3,0	0,015	0,013
12	34	M05	20	4,0	8,0	3,5	0,028	0,025
16	42	M05	26	4,0	8,0	5,0	0,062	0,060
20	47	M05	30	5,0	8,0	6,0	0,105	0,100
25	49	M05	30	5,0	8,0	8,0	0,170	0,165

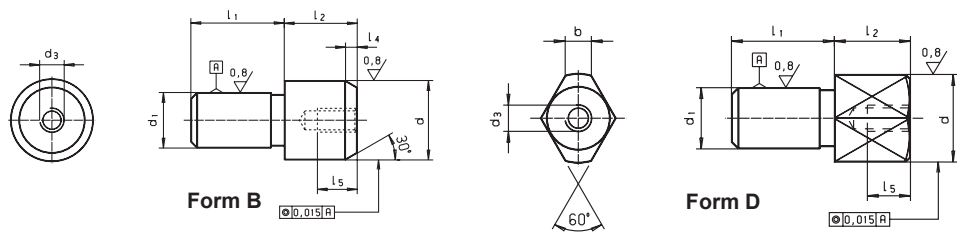

Catalog No.	Form	d	X	l <sub>2</sub>
SM 1280-5	B	16	X	14



d h6	l <sub>2</sub>	d <sub>1</sub> p6	d <sub>3</sub>	l <sub>1</sub>	l <sub>4</sub>	l <sub>5</sub>	b	kg	
10	11	07	M03	11	3,0	6,0	3,0	Form B	Form D
12	12	08	M05	13	4,0	8,0	3,5	0,012	0,011
16	14	12	M05	18	4,5	8,0	5,0	0,032	0,030
20	15	14	M05	22	5,0	8,0	6,0	0,052	0,050
22	17	16	M05	22	5,0	8,0	7,0	0,071	0,071
25	17	18	M05	25	5,0	8,0	8,0	0,096	0,094