

# SM 1291-01 \_\_\_\_\_ Zylinderschraube mit Innensechskant, niedriger Kopf

## DIN 6912 Hexagon socket head cap screw, shallow head

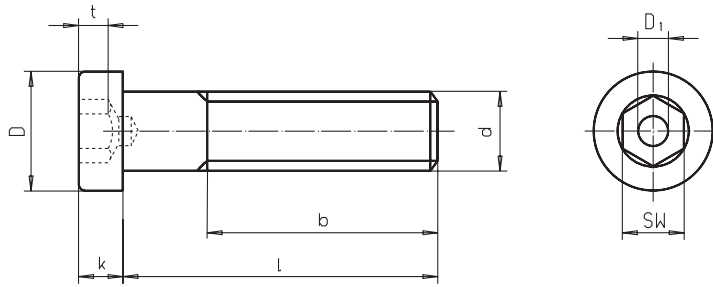

Catalog No.	d	X	l	Material
SM 1291-01	M08	X	30	ST

**ST:** Stahl, verzinkt  
steel, zinc plated

Festigkeitsklasse 8.8  
grade 8.8

mm



Reinigen mit  
**SM 1306**  
Clean with

Kleben mit  
**SM 1301**  
Lock with

b	14	16	18	22	26	30
D Ø	7,0	8,5	10,0	13,0	16,0	18,0
k	2,8	3,5	4,0	5,0	6,5	7,5
D <sub>1</sub> Ø	2,0	2,5	3,0	4,0	5,0	6,0
SW	03	04	05	06	08	10
t	1,48	1,88	2,38	2,88	3,35	3,85
l	d					
08	M04	M05	M06	-	-	-
10	M04	M05	M06	M08	-	-
12	M04	M05	M06	M08	-	-
16	M04	M05	M06	M08	M10	-
20	M04	M05	M06	M08	M10	M12
25	M04	M05	M06	M08	M10	M12
30	-	M05	M06	M08	M10	M12
35	-	-	M06	M08	M10	M12
40	-	-	M06	M08	M10	M12
45	-	-	M06	M08	M10	M12
50	-	-	M06	M08	M10	M12
60	-	-	M06	M08	M10	M12
70	-	-	-	M08	M10	M12

# SM 1291-02 \_\_\_\_\_ Sechskantschraube mit Schaft

## DIN 931 / ISO 4014 Hexagon head screw, metric coarse thread

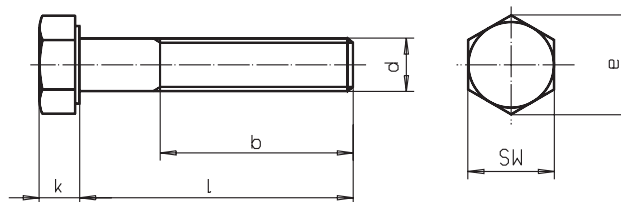

Catalog No.	d	X	l	Material
SM 1291-02	M08	X	035	ST

**ST:** Stahl, verzinkt  
steel, zinc plated

Festigkeitsklasse 8.8  
grade 8.8

mm

\* In Edelstahl rostfrei sind diese Längen nicht erhältlich.  
*In stainless steel not available.*

\*\* Schlüsselweite nach DIN ISO 272  
*Widths across flats, external like DIN ISO 272.*

, andere Abmessungen  
, other dimensions



Reinigen mit  
**SM 1306**  
Clean with

Kleben mit  
**SM 1301**  
Lock with

b	14	16	18	22	26	30
SW	07	08	10	13	17**	19**
e	7,66	8,79	11,05	14,38	18,90	21,10
k	2,8	3,5	4,0	5,3	6,4	7,5
l	d					
025	M04	M05*	-	-	-	-
030	M04	M05	M06	-	-	-
035	M04	M05	M06	M08	-	-
040	M04	M05	M06	M08	M10	-
045	M04	M05*	M06	M08	M10	M12
050	-	M05	M06	M08	M10	M12
060	-	M05	M06	M08	M10	M12
070	-	-	M06	M08	M10	M12
080	-	-	-	M08	M10	M12
090	-	-	-	-	M10	M12
100	-	-	-	-	M10	M12
110	-	-	-	-	-	M12
120	-	-	-	-	-	M12

